



AC Permanent Magnet Synchronous Motor

GF-64TYD

Featurers:

- Die casting gear box for heavy duty application
- Reliable starting and directional stability
- Virtually silent running for noise sensitive environments
- Speed state invariable not effected by voltage under rated frequency
- Winding will not ruin when motor over loading or abrupt stop running
- High quality engineering ensures a quiet and long running life

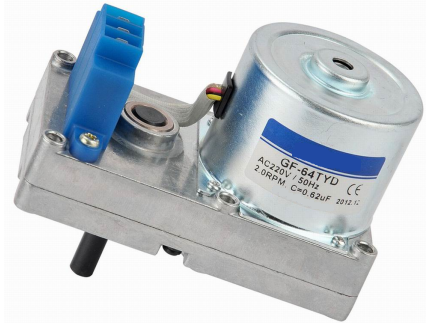

Applications:

Pellet Feeder, Pellet Stove Auger ,Pellet Burner, Pellet Grinder

Mechnical Dimensons

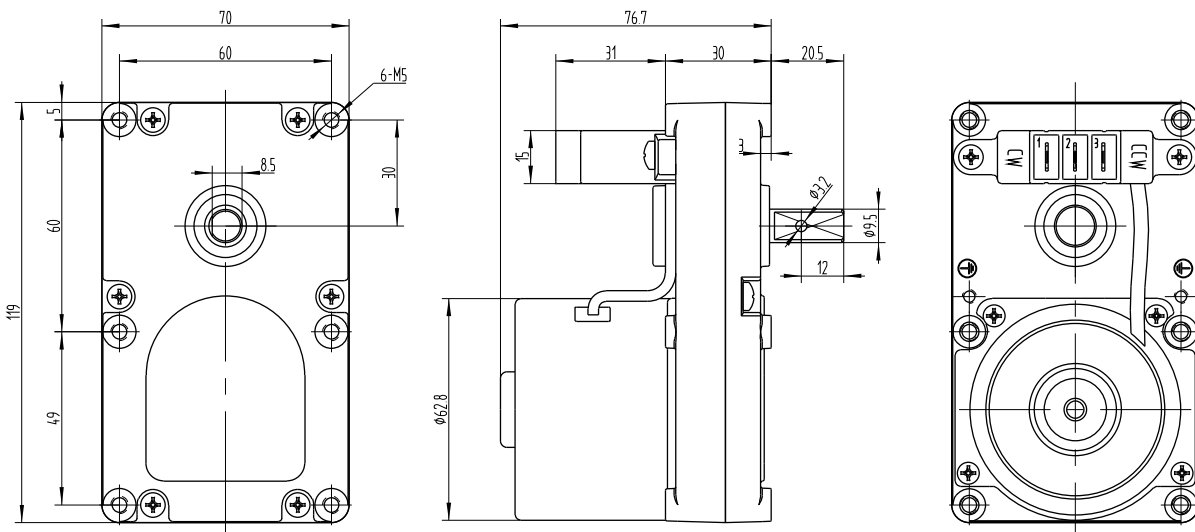

Electrical Specification

Spcification

ITEM	DATA		
Rated Voltage (V)	24	110-120	220-240
Rated Frequency (Hz)	50/60		
Input Power (W)	<20		
Input Current (A)	<0.9	<0.19	<0.010
Output Power (W)	5-8		
Noise (db)	<45		
Rotate direction	CW / CCW / Bi-directional		

Safety

ITEM	DATA
Insulation resistance	DC500V 100M Ohms
Insulation str.	AC1500V 50Hz/min(220V motor)
Insulation class	F(155° C)/B(120° C)
Environment	Temp:-10° C~+70° C / Humidity:<85%
Protection	Impedance
Certification	RoHS CE CCC

- If need running under low temp between(-40° C~-15° C) please notify us.

Speed&Torque

Speed	RPM	1.0	1.5	1.8	2.0	2.4	3.7	5.0	6.0	8.0
Torque	kgf.cm	280	250	220	200	180	160	120	100	75

- Above datas are from motors under 50Hz. If under 60Hz, SpeedX1.2, Torque /1.2
- Other speed and torque needed, please contact our sales department