



Brushless DC Gear Motor

GM25-TEC2430

- Small size dc gear motor with low speed and big torque
- 25mm gear motor provide 0.5Nm torque and more reliable
- Suitable to small diameter. Low noise and big torque application
- Reduction ratio: 4、10、21、34、45、47、73、78、103、130、172、227、378、499

Mechanical Dimensions

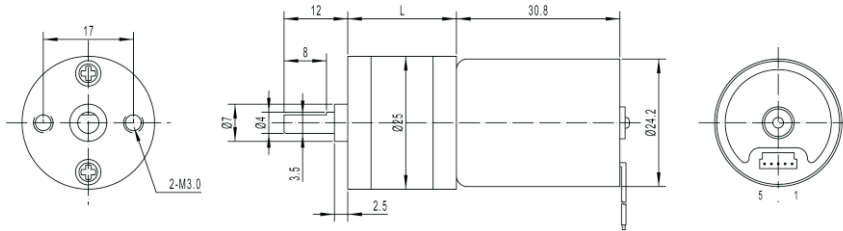

Gear Motor Dimensions (mm)



Electrical Specification

Motor model No.	Rated voltage	No-load speed	No-load current	Rated speed	Rated torque	Rated current	Output power	Stall torque	Stall current
	VDC	r/min	mA	r/min	g.cm	mA	W	g.cm	A
TEC2430-0645	6.0	4500	180	3500	62	570	2.2	120	1.4
TEC2430-1260	12.0	6000	180	4600	84	800	4.6	140	1.6
TEC2430-2490	24.0	9000	180	7200	90	500	6.7	180	1.9

Gearbox with motor: GM25-TEC2430-0645-XXX

Reduction ratio	4	10	21	34	47	78	103	130	227	499
Length mm	17	19	19	21	21	23	23	25	25	27
No-load speed rpm	1500	600	285	175	125	78	60	47	27	9
Rated speed rpm	1200	480	230	140	100	60	47	37	21	8
Rated torque kg.cm	0.06	0.14	0.29	0.4	0.6	0.9	1.1	1.4	2.5	5
Max.momentary tolerance torque kg.cm	0.3	0.7	1.5	2.1	3.0	4.9	6	8	10	10

GM25-TEC2430-1260-XXX

Reduction ratio	4	10	21	34	47	78	103	130	227	499
Length mm	17	19	19	21	21	23	23	25	25	27
No-load speed rpm	2100	850	400	250	180	110	83	66	38	17
Rated speed rpm	1750	700	335	205	150	90	68	54	31	15
Rated torque kg.cm	0.06	0.14	0.29	0.5	0.6	0.9	1.1	1.4	2.5	5
Max.momentary tolerance torque kg.cm	0.4	0.9	1.6	2.7	3.6	6.1	8	9	10	10

GM25-TEC2430-2490-XXX

Reduction ratio	4	10	21	34	47	78	103	130	227	499
Length mm	17	19	19	21	21	23	23	25	25	27
No-load speed rpm	2200	880	420	260	185	115	85	69	40	18
Rated speed rpm	1800	720	340	210	155	90	70	57	35	16
Rated torque kg.cm	0.29	0.6	1.3	1.8	2.5	4.2	5	5	5	5
Max.momentary tolerance torque kg.cm	0.6	1.3	2.6	3.7	5.1	8	10	10	10	10