

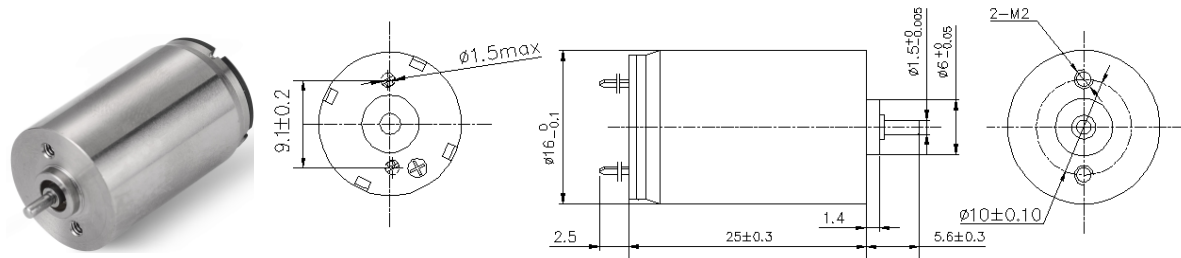

Coreless Brush DC Motor

LS-1625R



Typical Applications: Tattoo machine. Robot. Door lock. Robotic arm

电机参数 (Motor data)		32A	46A	21A	01A
额定电压下数值 (Values at nominal voltage)					
1 额定电压 (Nominal voltage)	V	4.5	5	6	12
2 空载转速 (No load speed)	rpm	7760	8260	6400	10050
3 空载电流 (No load current)	mA	25	25	10	15
4 额定转速 (Nominal speed)	rpm	6360	6880	5334	8930
5 额定转矩(最大连续转矩) (Nominal torque)	mNm	2	2	1.5	2.1
6 额定电流(最大连续电流) (Nominal current)	A	0.39	0.372	0.176	0.2
7 堵转转矩 (Stall torque)	mNm	11.1	12.15	9	18.8
8 堵转电流 (Stall current)	A	2.03	2.13	1.02	1.66
9 最大效率 (Max efficiency)	%	79	81	79	82
电机常数 (Motor constant)					
10 相间电阻 (Terminal resistance)	Ω	2.22	2.35	5.9	7.23
11 转矩常数 (Torque constant)	mNm/A	5.43	5.67	8.77	11.17
12 速度常数 (Speed constant)	rpm/V	1724	1652	1067	838

其他特性参数 Other characteristic parameters

- 13 环境温度范围 (Ambient temperature) -10~40°C
- 14 绕组最高允许温度 (Max permissible winding temperature) 80°C
- 15 最高允许转速 (Max permissible speed) 20000rpm
- 16 电极磁极对数 (Number of the pole pairs) 1
- 17 换向器片数 (Number of the commutator segments) 5
- 18 电机质量 (Weight) 24.35g

21A电机曲线图 motor curve

